

CTCDRH2D09F Series

From 1.2 μH to 10 μH



CHARACTERISTICS

Description: SMD (shielded) power inductor.

Applications: Power supplies for VTR, OA equipment, LCD televisions, PC notebooks, portable communication equipment, DC/DC converters, etc.

Operating Temperature: -40°C to +85°C

Inductance Tolerance: $\pm 30\%$

Testing: Inductance is tested on an HP4285A at 100KHz, 0.1V

Packaging: Tape & Reel.

Marking: Parts are marked with letter identifier.

Miscellaneous: **RoHS Compliant.**

Additional Information: Additional electrical & physical information available upon request.

Samples available. See website for ordering information.

SPECIFICATIONS

Parts are available in $\pm 30\%$ inductance tolerance only.
Inductance drop = 35% typ. at Isat.
 $\Delta T = 40^\circ\text{C}$ rise at Irms.

| Part Number | Marking | Inductance at 100KHz (μH) | Irms Max. (A) | Isat Max. (A) | DCR Max. (Ω) |
|------------------|---------|--|---------------|---------------|-----------------------|
| CTCDRH2D09F-1R2N | A | 1.20 | 1.24 | 0.80 | 0.0975 |
| CTCDRH2D09F-1R5N | B | 1.50 | 1.15 | 0.73 | 0.1100 |
| CTCDRH2D09F-1R8N | C | 1.80 | 1.06 | 0.65 | 0.1310 |
| CTCDRH2D09F-2R2N | D | 2.20 | 1.05 | 0.60 | 0.1440 |
| CTCDRH2D09F-2R5N | E | 2.50 | 0.98 | 0.53 | 0.1500 |
| CTCDRH2D09F-3R0N | F | 3.00 | 0.84 | 0.47 | 0.1940 |
| CTCDRH2D09F-3R9N | G | 3.90 | 0.72 | 0.45 | 0.2250 |
| CTCDRH2D09F-4R7N | H | 4.70 | 0.64 | 0.41 | 0.2880 |
| CTCDRH2D09F-5R6N | I | 5.60 | 0.59 | 0.37 | 0.3250 |
| CTCDRH2D09F-6R8N | J | 6.80 | 0.53 | 0.33 | 0.4250 |
| CTCDRH2D09F-8R2N | K | 8.20 | 0.46 | 0.30 | 0.4750 |
| CTCDRH2D09F-100N | L | 10.00 | 0.42 | 0.28 | 0.5380 |

PHYSICAL DIMENSIONS

| Size | A Max. | B Max. | C Max. | D Max. | E Ref. |
|--------|--------|--------|--------|--------|--------|
| mm | 3.2 | 3.2 | 1.0 | 4.3 | 1.0 |
| inches | 0.13 | 0.13 | 0.04 | 0.17 | 0.04 |

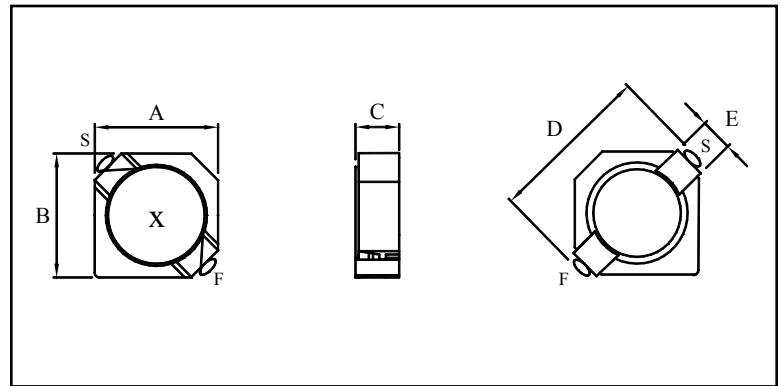

PAD LAYOUT

