

## CTEP105SF Series

From 0.22  $\mu\text{H}$  to 5.0  $\mu\text{H}$



### CHARACTERISTICS

- Description:** SMD Shielded Power Inductor.
- Applications:** LCD Television sets, Notebooks, PCs, Portable Communication equipment, DC/DC Converters, etc.
- Operating Temperature:** -40°C to +125°C
- Temp. Rise Current:** The actual current when temperature of coil becomes  $\Delta T=40^\circ\text{C}$  ( $T_a=20^\circ\text{C}$ )
- Inductance Tolerance:**  $\pm 20\%$ ,  $\pm 30\%$
- Testing:** Inductance is tested on an HP4285A at 100KHz, 0.25Vrms, 0Adc.
- Packaging:** Tape and Reel.
- Marking:** Parts are marked with inductance code.
- Miscellaneous:** **RoHS Compliant.**
- Additional Information:** Additional electrical & physical information available upon request.
- Samples available. See website for ordering information.**

### SPECIFICATIONS

Part numbers indicate inductance tolerance available.  
M =  $\pm 20\%$ , N =  $\pm 30\%$

Part Number	Inductance ( $\mu\text{H}$ )	L Test Freq. (KHz)	DCR Max. (m $\Omega$ )	Temp. Rise Current Typ. (A)
CTEP105SF-0R2N	0.22	100	1.7	19.0
CTEP105SF-0R4M	0.45	100	2.4	17.7
CTEP105SF-0R8M	0.80	100	4.1	13.0
CTEP105SF-1R3M	1.3	100	5.3	11.2
CTEP105SF-1R8M	1.8	100	7.5	9.0
CTEP105SF-2R5M	2.5	100	10.5	7.8
CTEP105SF-3R2M	3.2	100	12.4	7.4
CTEP105SF-4R0M	4.0	100	18.0	6.2
CTEP105SF-5R0M	5.0	100	23.8	4.9

### PHYSICAL DIMENSIONS

Size	A	B	C	D	E	F	G	H	J
	Max.	Max.	Max.						
mm	10.4	10.4	5.6	5.5	2.9	3.8	1.4	2.6	5.5
inches	0.409	0.409	0.22	0.217	0.114	0.150	0.055	0.102	0.217

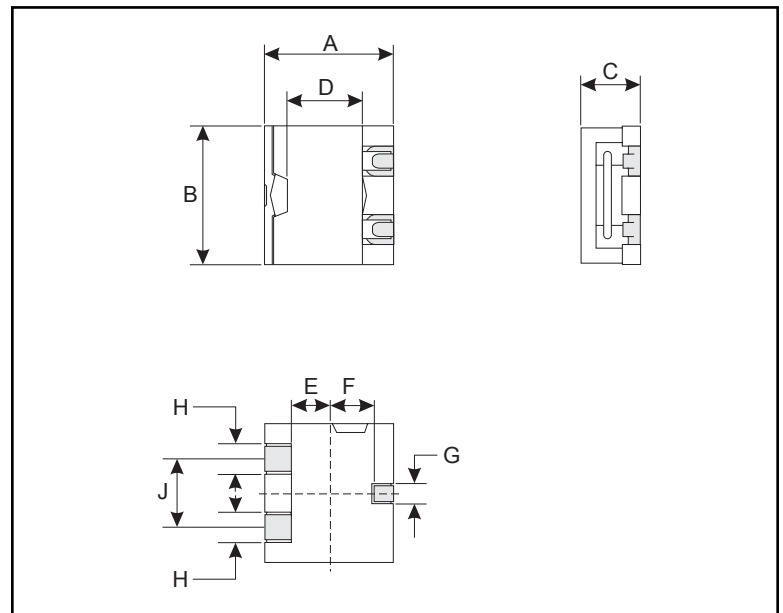

### PAD LAYOUT

