

CT0443164251F



CHARACTERISTICS

Description: Round Cable Snap On EMI Suppression Core
Applications: These cable cores will provide common-mode filtering for multi-strand cables and differential mode filtering for single conductors
Testing: Tested on a HP4287A at specified frequency
Packaging: Bulk
Marking: No marking
Miscellaneous: RoHS Compliant
Samples available. See website for ordering information.

SPECIFICATIONS

Part Number	Min. Impedance 25MHz (Ω)	Min. Impedance 100MHz (Ω)
CT0443164251F	132	200

PHYSICAL DIMENSIONS

Size	A	B	C	D	E Core Dimension
mm	20.5±1.0	20.0±1.0	7.5±1.0	33.0±1.0	6.5±0.3
inches	0.81±0.04	0.79±0.04	0.30±0.04	1.30±0.04	0.26±0.01

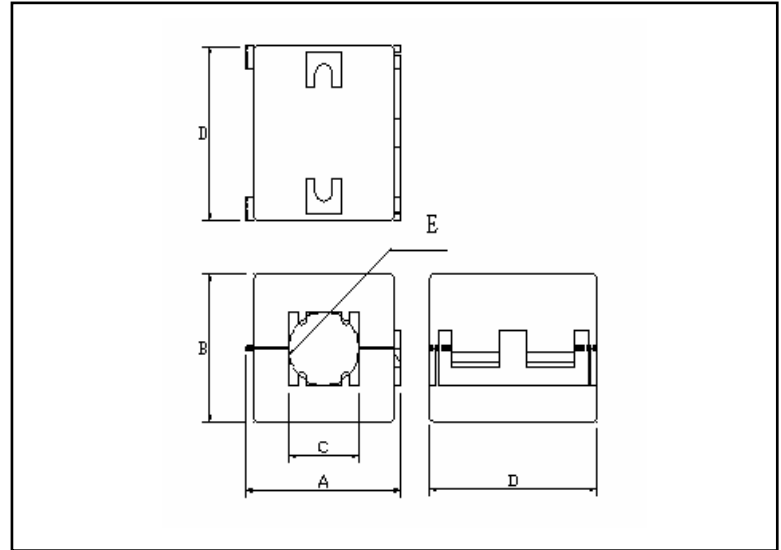

IMPEDANCE VS. FREQUENCY

